

PASSAGE DU HAVRE

The Passage du Havre is located in central Paris opposite the Gare Saint-Lazare leading to the two department stores Galerie Lafayette and Printemps situated on boulevard Haussmann. It is anchored by Fnac and sits at the heart of the Haussmann-Saint-Lazare shopping district, with excellent transport links.

ESG & AWARDS
BREEM[®]

PARIS – OPENED 1997
Refurbished in 2012

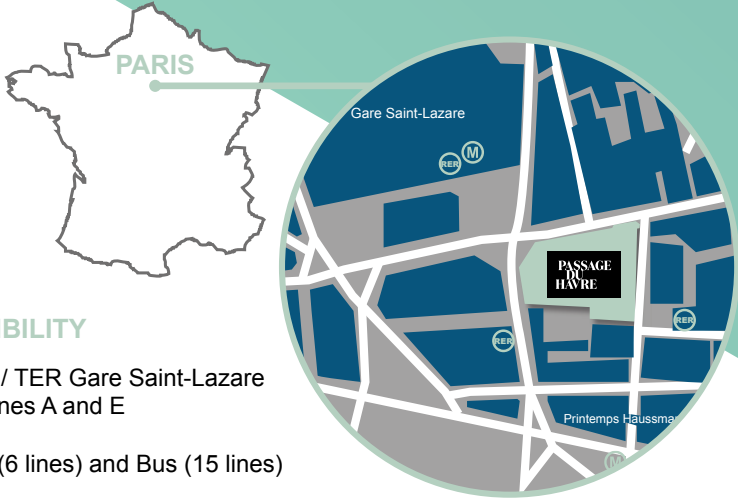

ACCESSIBILITY

- SNCF / TER Gare Saint-Lazare
RER lines A and E
- Métro (6 lines) and Bus (15 lines)
- Parking (174 spaces)

SERVICES

- Free Wi-Fi
- Loyalty Card
- Tax Free
- Digital Signage/Advertising



TOP BRANDS



23,881*
Gross lettable area

14,121
GLA Gallery

40
Number of stores

2 Medium units **5** Restaurants

7.4 million
Catchment
(within 20 minutes)

11.5 million
Number of visitors*

*GLAs may not add up due to rounding. Includes external units, offices and residential areas.

* Based on 2019 numbers



COMMERCIALISATION



Alice Risser
M. 00 33 (0)6 76 84 38 85
alice.risser@ecpnv.com

Christian Luc
M. 00 33 (0)7 78 82 91 21
christian.luc@ecpnv.com

Julia Forlini
M. 00 33 (0)6 38 55 71 24
julia.forlini@ecpnv.com

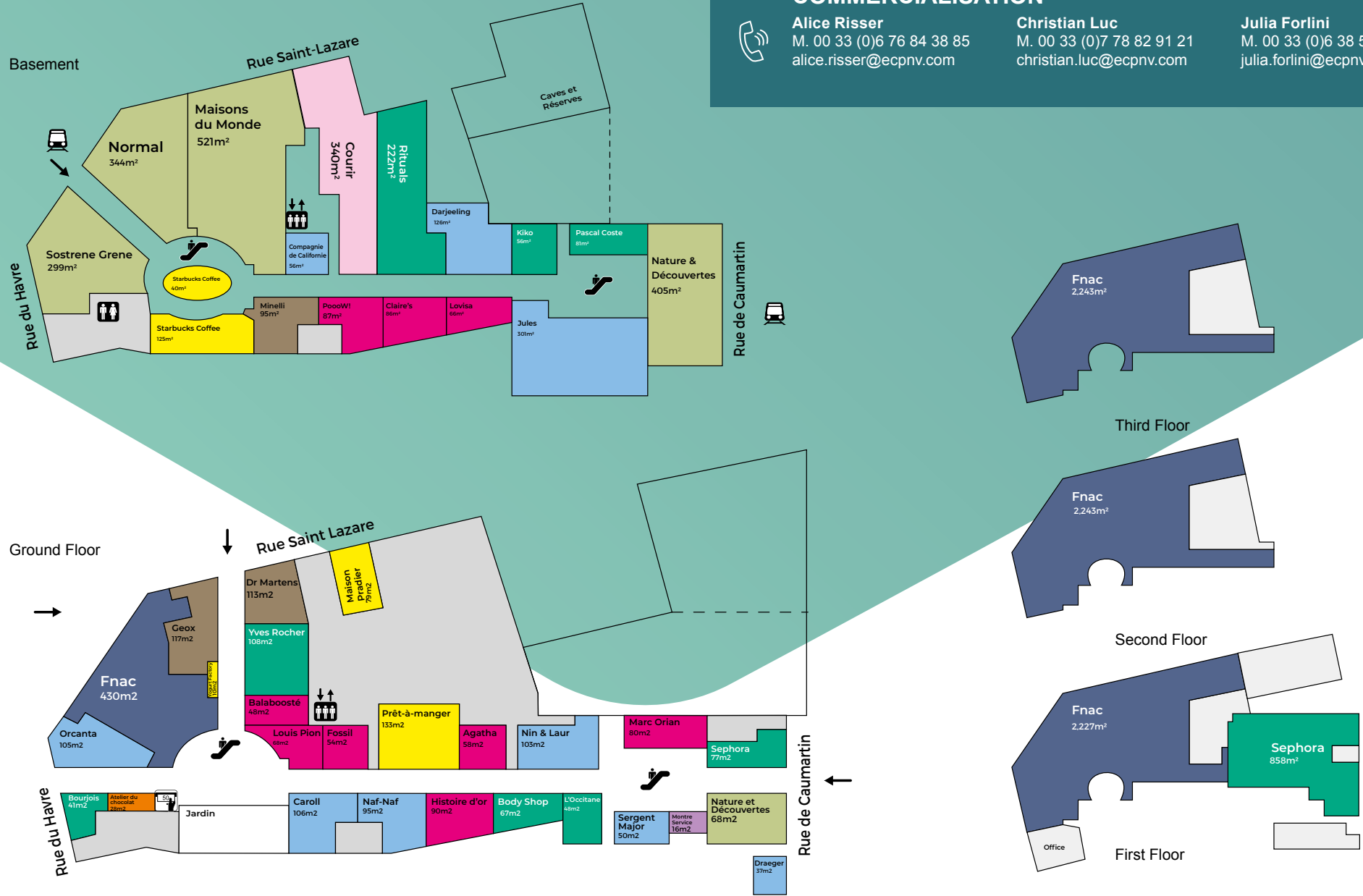

- Hypermarket
- Fashion
- Shoes
- Health & Beauty
- Gifts & Jewellery
- Books & Toys
- Food
- Restaurants
- Services
- Sport
- Home Goods
- Telecom & Electrical